

Meetings before the Symposium

Sunday, Sept. 4th

Working Bureau

14³⁰ – 17³⁰

Meeting of Working Bureau and guests.

Hilton Hotel, C. Silvestri room

Monday Sept. 5th

Venue

9³⁰ – 19⁰⁰

Venue and Handing over bags

with Proceeding Volumes, brochure, event tickets

Hilton Hotel Colonade

Monday September 5th

Executive Council

9³⁰ – 12³⁰ , 14⁰⁰ – 18⁰⁰

Meeting of Executive Council

Scientist House

(Casa oamenilor de Stiinta) Piata Lahovari, near Hilton (see map)

Monday Sept. 5th

Dinner

19⁰⁰ – 21⁰⁰

Presentation of Romanian wines.- transport by cars..

Complex Restaurant Astoria at Snagov lakeside

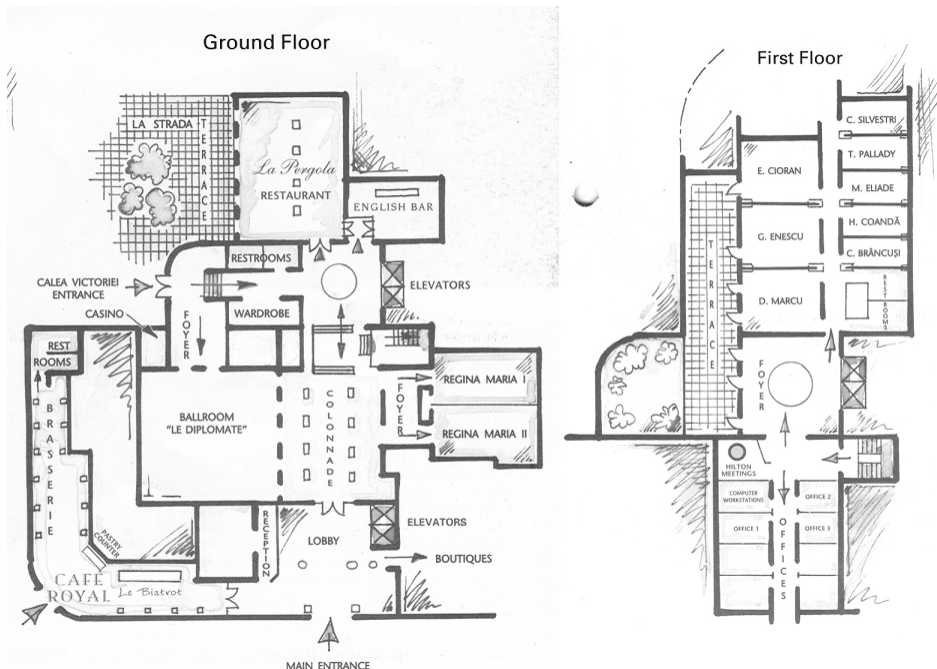

Hilton Plan

FINAL SCHEDULE OF IASS 2005 SYMPOSIUM SESSIONS

Bucuresti and Poiana Brasov, September 6th – 10th 2005

Tuesday Sept. 6th

Opening Session

9⁰⁰ – 10³⁰

Symposium Official Opening Foreword and Welcome Addresses, Musical Entertainment Royal Palace Hall

Coffee break

Tuesday Sept. 6th

Plenary Session 1

10⁴⁵ – 12⁴⁵

Key lectures of 30 minutes

Royal Palace Hall

Chairmen G.C. Giuliani and R. Isopescu

ESTHETICS IN SEISMIC IMPROVEMENT AND RETROFIT

M. Kawaguchi

THE HIGH-RISE BUILDING HOW HIGH CAN WE GO?

Leslie E. Robertson, Saw-Teen See

STRUCTURAL DESIGN AND CONSTRUCTION OF THE TAIPEI 101

Maw-Shyong Sheu, Pai-Mei Liu

THE ULTIMATE SKYSCRAPER

Matthys Levy

Coffee break

Tuesday Sept. 6th

Plenary Session 2

13⁰⁰ – 14⁰⁰

Key lectures of 30 minutes

Royal Palace Hall

Chairmen M. Kawaguchi and P. Mazilu

FREEFORM GLASS ROOFS AND FACADES

Jörg Schlaich, Hans Schober, Thomas Moschner

FABRIC STRUCTURES FOR PERMANENT BUILDINGS – THEIR PAST AND THEIR FUTURE

Horst Berger

Lunch at Hilton Hotel Restaurant Diplomat 14⁰⁰ - 15⁰⁰

Tuesday Sept. 6th

Plenary Session 3

15¹⁰ – 16⁴⁰

Key lectures of 30 minutes

Royal Palace Hall

Chairmen J.K. Abel and S. Sturza

PERFORMANCE-BASED SEISMIC DESIGN PROVISIONS FOR BUILDINGS IN JAPAN

Midorikawa Mistumasa

ARCHITECTURAL ENGINEERING: "ELEARNING EXPERIENCES AT THE FACULTY OF ARCHITECTURE IUAV IN VENICE"

E. Siviero, M. Petrucci, M. Mantoan

HAGIA SOPHIA AND MIMAR SINAN: HOW TO STRENGTHEN THE ROOF

I. Mungan

Coffee break

Tuesday Sept. 6th

Plenary Session 4

16⁵⁵ – 18⁵⁵

Key lectures of 30 minutes

Royal Palace Hall

Chairmen J. Schlaich and R. Angelescu

TENSEGRITY SYSTEMS: FROM SIMPLE TO COMPLEX CELLS

R. Motro

SPATIAL STRUCTURES AS BRIDGE BETWEEN CHINA AND THE WORLD

Tien T. Lan

RELIABILITY UNDER WIND LOADS OF THE BRANCUSI ENDLESS COLUMN, ROMANIA

D. Lungu, R. Vacareanu, G. Solari, A. Villa, G. Bartoli, M. Righi

CHANCES OF NATURAL DESIGN IN THE NEW CENTURY

Michael Balz

Tuesday Sept 6th

Opening Cocktail

19¹⁵ – 21³⁰

Symposium opening cocktail, transport by cars.

*at the picturesque lakeside
Snagov near Bucharest*

Wednesdays Sept. 7th

Concurrent Session 1

9⁰⁰ – 10⁴⁵

Key lecture 30 minutes and invited lectures 25 minutes

Royal Palace Hall

Chairmen M. Levy and E.B. Popescu

INSTABILITY PROBLEMS OF SHELLS: GENERAL REPORT PART ONE: THEORETICAL ASPECTS

V. Gioncu (Key lecture)

EXPERIENCE OF APPLICATION OF REINFORCED CONCRETE SPATIAL STRUCTURES IN RUSSIA

V.V. Shugaev

MEGA TOWERS AND I.P.L SPACE FRAMES

Michael Burt

GRP SANDWICH STRUCTURES FOR 'LIQUID DESIGN' ARCHITECTURE

M. Eekhout, R. Visser

Coffee break

Wednesdays Sept. 7th

Concurrent Session 2

11⁰⁰ – 12⁴⁰

Invited lectures 25 minutes

Royal Palace Hall

Chairman S. Kato and M Postelnicu

GROWTH OF CONCRETE SHELLS AND STEEL FRAMES IN INDIA DURING LAST FEW DECADES

R. Sundaram

CASINO MORONGO "DESERT BLOOM" PORTE COCHERE, CABAZON, CALIFORNIA

T.J. Dehghanyar, A. Khalil, S. Tankha

NEW DEVELOPMENTS IN THE SPATIAL STRUCTURES FIELD IN CHINA

Xiliang Liu

DIGITAL BUILDING TECHNOLOGY: WOOD COMPOSITE SHELLS

D. Clifford, J. Kennedy

Coffee break

Wednesdays Sept. 7th

Concurrent Session 3

12⁵⁰ – 14¹⁰

Invited lectures of 20 minutes

Royal Palace Hall

Chairman H. Berger and M. Brumaru

RESPONSE OF THE "ENDLESS COLUMN" UNDER WIND ACTION

H. Yamada

TOPOLOGY OF THE ENDLESS COLUMN

Ramiro A. Sofronie

SIMULTANEOUS ENGINEERING IN SHELL DESIGN AND CONSTRUCTION

I. Ortega

THE EFFECT OF THE POSITION OF OPENINGS TO THE FAILURE BEHAVIOR OF THE FREE-FORMED REINFORCED CONCRETE SHELL

M. Takayama, N. Suzuki, Y. Omori

Lunch at Casa oamenilor de stiinta 14¹⁰ - 15¹⁰

Wednesdays Sept. 7th

Concurrent Session TH1

15²⁰ – 16⁴⁰

Theory

Royal Palace Hall

Invited lectures of 20 minutes

Chairmen K Ishii and D Lungu

NEW MATERIALS FOR STRUCTURES: PROJECT OF A CONCRETE CABLE-STAYED BRIDGE DRAWN UP WITH RECYCLED CONCRETE

P. Alaejos, A. Domingo, C. Lázaro, S. Monleón, M. Sánchez

FORM FINDING BY ALTERED ITERATIVE SMOOTHING METHOD COMBINED WITH DYNAMIC FINITE ELEMENT ANALYSIS

H. Tamai, M. Elnimeiri

BUCKLING BEHAVIOR OF COMPRESSIVE TUBULAR COLUMNS WITH ADDITIONAL BUCKLING RESTRAINER

K. Suzuki, T. Takeuchi, T. Marukawa, Y. Kimura, T. Sugiyama, T. Ogawa, S. Kato

NUMERICAL STUDIES ON BASE ISOLATED SEMIRIGID STEEL STRUCTURES

P. Alexa, A. Catarig, H. Mociran, Aliz Mathe

Coffee break

Wednesdays Sept. 7th

Concurrent Session TH2

16³⁰ – 18⁴⁰

Seismic Behaviour

Invited Lectures of 20 minutes

Royal Palace Hall

Chairman: R. Astudillio and D. Ioni ta

A STUDY ON THE SEISMIC PERFORMANCE OF SHELL AND SPATIAL STRUCTURES

I. Tatemichi, S. Kato

ON THE SEISMIC INPUT FOR THE ANALYSIS OF SPATIAL STRUCTURES

H. Sandi

DAMAGE INVESTIGATIONS OF PUBLIC HALLS IN NAGAOKA CITY AFTER NIIGATA-CHUETSU EARTHQUAKE 2004 IN JAPAN

K. Kawaguchi, Y. Suzuki

SEISMIC ISOLATION OF LATTICE SHELLS USING A NEW TYPE OF SMA-RUBBER BEARINGS

S. D. Xue, P. Zhuang, B. S. Li

Wednesdays Sept. 7th

Concurrent Session TECH1

9⁰⁰ – 10¹⁵

Technique

Regina Maria I Room (Hilton Hotel)

Normal lectures of 18 minutes

Chairmen: N.K. Srivastava and Gh. Pop

PRE-STRESS EFFECT ON STRUCTURAL BEHAVIOUR OF TENSION-STRUT STRUCTURES

K. K., Vu, J.Y. Richard Liew, Krishnapillai Anandasivam

AN INVESTIGATION ON THE DEPLOYABILITY OF TENSIONED MEMBRANE STRUCTURES

T.C. Tran, J.Y. Richard Liew, A. Krishnapillai

UP-TO-DATE QUESTIONS RELATED TO THE PRESTRESSED CONCRETE PREFABRICATION IN ROMANIA

A. Popaescu

MULTIFUNCTIONAL PREFABRICATED REINFORCED CONCRETE STRUCTURES FOR CIVIL AND INDUSTRIAL BUILDINGS

M. Brumaru, M.I. Agachi

Wednesdays Sept. 7th

Concurrent Session VL1

9⁰⁰ – 10¹⁵

Valuation

D. Marcu Room (Hilton Hotel)

Normal lectures of 18 minutes

Chairmen: M. Balz and M. Smighelschi

(UN)SINCERITY IN THE EXTERIOR EXPRESSION: SPATIAL STRUCTURES IN THE AVANTGARDE ARCHITECTURE

M. Bostenaru Dan

SMART - OR HOWEVER WE CALL IT...

Patrick Teuffel

USING RAPID PROTOTYPING FOR FREE-FORM SHAPES IN ARCHITECTURAL SCALE MODELS

J. Sánchez, J.Gonzalez Prada, A.Oyarbide

PYRAMID TYPE STRUCTURES

O. Groza

Coffee break

Wednesdays Sept. 7th

Concurrent Session TH2

10³⁰ – 12⁰⁰

Technique

Regina Maria I Room (Hilton Hotel)

Normal lectures of 18 minutes

Chairmen: A. Samartin and O. Groza

IMPROVING VIBRATION CHARACTERISTICS OF MIXED BUILDING STRUCTURE USING DOUBLE LAYER LATTICED WALL STRUCTURE

K. Ishikawa

BUCKLING LOADS OF ELLIPTIC PARABOLOIDAL SINGLE LAYER RETICULAR DOMES UNDER UNIFORM LOAD OF RECTANGULAR PLAN

S. Kato, Y. Yamauchi, T. Yamashita, T. Iijima

BUCKLING BEHAVIOR OF TH-H & H-TH MESH DOUBLE-LAYER GRIDS

Yoshiya Taniguchi Toshitsugu Saka, Masahiro Kurano

STABILITY ANALYSIS OF VARIABLE BOX CROSS-SECTION STEEL ARCH STRUCTURE OF BEIJING CAPITAL INTERNATIONAL AIRPORT

J. Ma, Z. Y. Zhu, D. Zhou

Wednesdays Sept. 7th

Concurrent Session TECH2

10³⁰ – 12⁰⁰

Technique

D. Marcu Room (Hilton Hotel)

Normal lectures of 18 minutes

Chairmen: M. Takayami and P. Alexa

THE NEW ROMANIAN CODE FOR THIN REINFORCED CONCRETE SHELLS
PART ONE: THEORETICAL APPROACH AND STRUCTURAL ANALYSIS

M. Mihailescu, C. Mircea

SEISMIC PROTECTION OF MASONRY BUILDINGS

Ramiro A. Sofronie

EXPERIMENTAL STUDY OF SINGLE LAYER TWO-WAY GRID DOME COMPOSED OF KITRUS WOODEN SPACE TRUSS SYSTEM WITH PC BAR AS DIAGONAL MEMBERS

M. Fujimoto, K. Imai, M. Ikemoto, T. Machinaga, S. Kushima

DEVELOPMENT OF WOODEN PREFABRICATED TRUSS SYSTEM

Atsuo Takino, Katsuhiko Imai

Coffee break

Wednesdays Sept. 7th

Concurrent Session TH3

12¹⁵ – 13⁴⁵

Theory

Regina Maria I Room (Hilton Hotel)

Normal lectures of 18 minutes

Chairmen: V. Gordeiev and D. Precupanu

SPATIAL STRUCTURES AT NANOSCALE

Heinrich Rothert, Gerald Ernst, Lutz Nasdala

THE TIME FACTOR EFFECTS IN THE ANALYSIS OF SPATIAL REINFORCED CONCRETE STRUCTURE AND FOUNDATION SOIL INTERACTION

D. Anastasescu

ANALYSIS OF FACTORS AFFECTING DYNAMIC VIBRATION CHARACTERISTICS OF MONOLAYER CABLE NET FOR POINT SUPPORTED GLASS CLADDING

L.L. Wu, Y.Q. Wang, Y.J. Shi

NUMERICAL ANALYSIS FOR WIND-INDUCED DYNAMIC RESPONSE OF GTC OF BEIJING CAPITAL INTERNATIONAL AIRPORT

D. Zhou, J. Ma, S. L. Dong, Z. Y. Zhu

A STUDY ON DAMPING CHARACTERISTICS OF A CONICAL SHELL

K. Shingu, K. Hiratsuka, T. Tanaka, Y. Aoki, T. Irie, K. Mitsui, K. Ogawa

Wednesdays Sept. 7th

Concurrent Session VL2

12¹⁵ – 13⁴⁵

Building Art

D. Marcu Room (Hilton Hotel)

Normal lectures of 18 minutes

Chairmen: E. Siviero and D. Opincariu

ONE AGE OF TANK BUILDING

B.V. Popovsky

EVALUATION OF HISTORICAL CONCRETE STRUCTURES

F. Aköz, G. Arun

THE RELATION BETWEEN OLD AND NEW. A CRITICAL APPROACH

Ana-Maria Dabija

ON THE RELATIONSHIP BETWEEN THE ARCHITECTURAL FORM, THE STRUCTURAL FORM AND THE FREE FORM

D. Dragan

Lunch at Casa oamenilor de stiinta 14¹⁰ – 15¹⁰

Wednesdays Sept. 7th

Concurrent Session TH4

15¹⁵ – 16⁴⁵

Theory

Regina Maria I Room (Hilton Hotel)

Normal lectures of 18 minutes

Chairmen: V. V. Shugaev and V. Gioncu

STUDY ON SEISMIC RESPONSE ESTIMATION BASED ON PUSHOVER ANALYSIS FOR MEMBRANE STRUCTURE SUPPORTED BY SUBSTRUCTURE

Shoji Nakazawa, Shiro Kato, Tatsuya Yoshino, Kenshi Oda

SHAPING THE SLENDER STRUCTURES UNDER WIND FLOW

C. A. Safta

SEISMIC RESPONSE BEHAVIOR OF SINGLE LAYER LATTICED CYLINDRICAL ROOFS AND THE LOAD MODELING FOR SEISMIC DESIGN

Seishi Yamada, Yukihiko Matsumoto, Eiji Saito

WIND INDUCED VIBRATION ANALYSIS ON SPHERICAL SHELLS

Zhi-hong Zhang, Yukio Tamura

Wednesdays Sept. 7th

Concurrent Session VL3

15¹⁵ – 16⁴⁵

Valuation

D. Marcu Room (Hilton Hotel)

Normal lectures of 18 minutes

Chairmen: M. Eekhout and C. Mircea

REASSESSMENT OF LESSONS LEARNED FROM SHELLS FOR SPATIAL MULTI-STOREY STRUCTURES

M. Bostenaru Dan

CUTTING PATTERNS FOR INFLATABLES: SOCCER BALL DESIGNS

T. Tarnai

ASPECTS CONCERNING CONSTRUCTION AND DURABILITY OF REINFORCED CONCRETE SHELLS

D. Georgescu, D. Dobre

MORPHOLOGY OF COMPLEX FORMS

A. Bögle

Coffee break

Wednesdays Sept. 7th

Concurrent Session TH5

17⁰⁰ – 18⁴⁵

Theory

Regina Maria I Room (Hilton Hotel)

Normal lectures of 18 minutes

Chairmen: L. Robertson and R. Sofronie

AN OPTIMIZATION APPROACH TO DESIGN OF GEOMETRY AND FORCES OF TENSEGRITIES

M. Ohsaki, J.Y. Zhang, S. Kimura

PLATE BASED TENSEGRITY STRUCTURES

Andreas Falk, Gunnar Tibert

STRESS-LOOP AND TENSEGRITY

J.C. Cui, Z.B. Lin, R.J. Qian

THE NEXT STEP IN MODELLING FOR STRUCTURAL DESIGN: STRUCTURAL DESIGN TOOLS

J.L. Coenders, L.A.G. Wagemans

Wednesdays Sept. 7th

Concurrent Session TH6

17⁰⁰ – 18⁴⁵

Theory

D. Marcu Room (Hilton Hotel)

Normal lectures of 18 minutes

Chairmen: T. T. Lan and H. Sandi

INSTABILITY PROBLEMS OF SHELLS: GENERAL REPORT:

PART TWO: PRACTICAL ASPECTS

V. Gioncu

OPTIMIZATION OF THE SIZING OF AXISYMMETRIC SHELL

J. Sumec, N. Jendželovský

BRIDGE DESIGN APPROACH IN THE FACULTY OF ARCHITECTURE

E. Siviero, F. Mutignani, V. D'Aguzzo

AN EIGHT-NODE HEXAHEDRON ELEMENT WITH REDUCTION OF SHAPE SENSITIVITY AND HIGH PERFORMANCES IN SHELL APPLICATIONS

A. Dósa

Thursday Sept. 8th

Concurrent Session TECH3

9⁰⁰ – 10³⁰

Technique

Regina Maria I Room (Hilton Hotel)

Normal lectures of 18 minutes

Chairmen: R. Sundaram and V. Pacurar

A DESIGN ORIENTED, USER FRIENDLY FORM FINDING PROGRAM

Horst Berger

THE NEW ROOF OF THE OLYMPIC STADIUM IN BERLIN

D. Constantinescu

STRUCTURAL DESIGN OF SIMOKITA DOME

O. Hosozawa, T. Mizutani

STRUCTURE FOR TWELVE DOLPHINS

R.E. Shaeffer, Hugh Bradford Nicholson

Thursday Sept. 8th

Concurrent Session TH7

9⁰⁰ – 10³⁰

Theory

D. Marcu Room (Hilton Hotel)

Normal lectures of 18 minutes

Chairmen: I. Ortega and Tr. Pop

ON THE FEASIBILITY OF TENSIONED FABRIC CONE STRUCTURES WITHOUT RADIAL CABLES

Slade Gellin

TRANSFORMABLE SYSTEM USING WIRE CABLE

S. Morooka, K. Nishino, H. Tanaka

THE DESIGN OF MEMBRANE STRUCTURES USING DIRECT PERFORMANCE MANIPULATION METHOD

K. Uetani, M. Yamakawa, S. Yoshitomi

A SHAPE-FINDING ANALYSIS BY RESIDUAL OF EQUILIBRIUM EQUATION AS LINEAR PROBLEM

T. Tanami

Thursday Sept. 8th

Concurrent Session MT1

9⁰⁰ – 10³⁰

Maintenance lectures

G. Enescu Room (Hilton Hotel)

Normal lectures of 18 minutes

Chairmen: I. Mungan and I. Bucur

CONCRETE SHELLS: CAST IN SITU-PRECAST-PRESTRESSED

M. Mihailescu, R. Sundaram

SERB-I DEVICES FOR THE REHABILITATION OF HISTORICAL MONUMENTS

V. Serban, A. Panait, T. Sireteanu, D. Cretu

REINFORCING OF SPACE STEEL STRUCTURES

Z. Agócs, J. Brodniansky

ENHANCING THE PERFORMANCES OF NATURAL STONE MASONRY

E. Juhászová, E. Coelho, R. Bairrao, A. Costa, A. Virsta, R.A. Sofronie

BUILDING DEMOLITION BY CONTROLLED EXPLOSION - STATE OF THE ART

H. Puscau, M. Brumaru

Coffee break

Thursday Sept. 8th

Concurrent Session TECH4

10⁰⁰ – 12¹⁰

Technique

Regina Maria I Room (Hilton Hotel)

Normal lectures of 18 minutes

Chairmen: M. Burt and L. Brezeanu

STRUCTURAL DESIGN OF SAMOA AQUATIC CENTER

Qin Yafei, Zhang Qilin

THE SANTA CATERINA'S MARKET ROOF COVER IN BARCELONA

Jose M^a Velasco Rivas

AN INHABITED SKYSCRAPER BRIDGE FOR THE MESSINA STRAIT CROSSING

E. Siviero, P. Michieletto, R. Nicolin

THE ROOF STRUCTURE DESIGN OF JILIN SPEEDSKATING GYMNASIUM

Wang Hongjun, Zhang Qilin

Thursday Sept. 8th

Concurrent Session TH8

10⁰⁰ – 12¹⁰

Theory

D. Marcu Room (Hilton Hotel)

Normal lectures of 18 minutes

Chairmen: K. Kawaguchi and C. Dico

TWO-MODES PUSHOVER ANALYSIS FOR RETICULAR DOMES FOR USE OF PERFORMANCE BASED DESIGN AND FOR ESTIMATING RESPONSES TO SEVERE EARTHQUAKES

S Kato, S Nakazawa, K Saito

THE BEHAVIOUR OF FULLY ENCASED COMPOSITE COLUMNS UNDER CYCLIC LOADS AND DISSIPATIVE INTERPRETATION FOR SEISMIC DESIGN

C. Campian, V. Pacurar

A PRACTICAL APPROACH TO DESIGN OF STRUCTURES: A LEARNING EXPERIMENT THROUGH RESEARCH, DESIGN AND PHYSICAL MODELLING

Amir E. Piroozfar, Olga Popovic Larsen

APPLICATION OF THE DAMAGE CONTROL DESIGN TO AN ARCH

K. Yamada, K. Ishihara

Thursday Sept. 8th

Concurrent Session TH1

10⁵⁵ – 12¹⁰

Theory

G. Enescu Room (Hilton Hotel)

Normal lectures of 18 minutes

Chairmen: G.:Arun and S. Tiganas

LOW-TECH MEMBRANES AND THE CREATIVITY JUMP TO ARCHITECTURE

Elisa Gutierrez, Olga Popovic

DYNAMIC LOADING EXPERIMENT OF FULL SCALE MDEL OF WOODEN SPACE FRAME SYSTEM - A FURTHER STUDY ON RESPONSE AMPLITUDE DEPENDENCY OF MODAL DAMPING FACTORS

R. Inoue, K. Nishio, K. Oe, M. Ikemoto, M. Fujimoto, T. Furukawa, K. Imai, X.G. Lin

SEISMIC RESPONSE EVALUATION OF LATTICED DOMES WITH ELASTO-PLASTIC SUBSTRUCTURES USING AMPLIFICATION FACTORS

T. Kumagai, T. Takeuchi, T. Ogawa, A. Nakama, E. Sato

SEISMIC RESPONSE EVALUATION OF CYLINDRICAL LATTICE SHELL ROOFS WITH SUBSTRUCTURES USING AMPLIFICATION FACTORS

T. Takeuchi, T. Ogawa, C. Yamagata, T. Kumagai

Coffee break

Thursday Sept. 8th

Concurrent Session MT2

12⁰⁰ – 14⁰⁰

Maintenance

Regina Maria I Room (Hilton Hotel)

Normal lectures of 18 minutes

Chairmen: V. Gordeiev and D. Precupanu

A DEPLOYABLE, SELF STABILIZING, ARCH-SHAPED STRUCTURE

Silvia Briccoli Bati, Alessandra Foschi, Tommaso Rotunno

DESIGN METHODOLOGIES FOR THE ASSESMENT AND RETROFITING OF THE EXISTING MASONRY BUILDINGS

Gh. Popescu, R. Popescu

CONSIDERATIONS CONCERNING THE DESIGN OF PRESTRESSED FRAMES SUBJECTED TO HORIZONTAL FORCES

D. Precupanu, C. Precupanu, V. Seremet, C. Calistru

PROBABILISTIC STRUCTURAL DETERMINATION OF A SHELL BOX – DECK SUSPENSION BRIDGE UNDER WIND AND TRAFFIC ACTIONS

E. Dragomirescu, H. Yamada, H. Katsuchi

SERB-B TYPE DEVICES FOR CONTROLLING THE JOINTS AND THE DISTORTIONS OF THE SPATIAL STRUCTURE

V. Serban, A. Panait, T. Sireteanu, M. Stoica

Thursday Sept. 8th

Concurrent Session TECH5

12⁰⁰ – 14⁰⁰

Technique

D. Marcu Room (Hilton Hotel)

Normal lectures of 18 minutes

Chairmen: R.E. Shaeffer and C. Campian

3D TUBULAR MESH AS A GIRDER FOR BRIDGE DESIGN

B. Briseghella, E. Siviero, T. Zordan

COMPUTATIONAL MORPHOGENESIS OF STRUCTURES BY EXTENDED ESO METHOD ~ APPLICATION TO DYNAMIC PROBLEMS

Tomoya Aou, Hiroshi Ohmori

STUDY ON BEARING CAPACITY OF WELDED HOLLOW SPHERE JOINT UNDER TENSION AND COMPRESSION

Zhihua Chen, Xiaodun Wang, Xiangyu Yan

COMPUTER ANALYSIS OF COMPOUND CURVED SANDWICH SHELL STRUCTURES

G. Gaston, D. Thambiratnam, C. Button

IMPROVEMENT SEISMIC DESIGN FOR THE HISTORICAL LONG SPAN WOODEN BUILDING WITH THE WOODEN SEISMIC-BRACING SYSTEM

K.Matsuno, T.Yamabe, T.Syoda, J.Baba, D.Nakashima, N.Aida

Thursday Sept. 8th

Concurrent Session TH9

12⁰⁰ – 13⁰⁰

Theory

G. Enescu Room (Hilton Hotel)

Normal lectures of 18 minutes

Chairmen :P. Teuffel and M.I. Agachi

A NEW PROCEDURE FOR FORM-FINDING OF TENSION MEMBRANE STRUCTURES

Wang Chunjiang , Zhou Dai

COMMUTATIVE ALGEBRA IN STRUCTURAL ANALYSIS OF DEPLOYABLE TENSION-STRUT STRUCTURES

K.K. Vu, J.Y. Richard Liew, Anandasivam Krishnapillai

FORM-FINDING OF SELF-STRESSED STRUCTURES BY AN EXTENDED FORCE DENSITY METHOD

Jingyao Zhang, Makoto Ohsaki

NATURALLY- INFORMED DESIGN: BACK IN HARNESS, THE LONG MARCH OR A NEW TERRITORY ?

Amir E. Piroozfar, Roger J. Plank

STRUCTURAL ASSESMENT AND REHABILITATION OF R/C SHELL STRUCTURES

A. Catarig, L. Kopenetz, P. Alexa

Lunch in an Bucharest Restaurant with specific Romanian meals

Thursday Sept. 8th

Concurrent Session MT3

15¹⁵ – 16³⁰

Maintenance

Regina Maria I Room (Hilton Hotel)

Normal lectures of 18 minutes

Chairmen :K. Mashita and A. Popaescu

ANALYSIS OF SPATIAL NETS ALLOWING FOR SLIPPERY ROPES

V. Gordeiev, M. Shymanovska

EXPERIMENTAL WOOD-BOLT CONNECTIONS BY APPLICATION OF MOIRÉ TECHNIQUE

M.A. Demarzo, I.M. Dal Fabbro, E.A. Affonso

NON-LINEAR ANALYSIS FOR ULTIMATE LOADING CAPACITY OF CAST TUBULART-JOINTS

P. Sun, Y.J. Shi, Y.Q. Wang

AN EXPERIMENTAL TOOL FOR QUALITATIVE UNDERSTANDING OF STRUCTURAL BEHAVIOUR IN FREE FORM STRUCTURES

R. Di Marco, C. Silvestri, E. Siviero

Thursday Sept. 8th

Concurrent Session TH10

15¹⁵ – 16³⁰

Theory

D. Marcu Room (Hilton Hotel)

Normal lectures of 18 minutes

Chairmen :D. Clifford and C.A. Safta

FOLDING/UNFOLDING OF TENSEGRITY SYSTEMS BY REMOVAL OF SELF-STRESS

A. Smaili, R.Motro

ANALYSIS OF MASONRY CONSTRUCTIONS BY MEANS OF CATENARY CABLE

P. Roca, A. Andreu, L. Gil

DEPLOYABLE MEMBRANE STRUCTURE BASE ON BENNETT 4R LINKAGE

Yaozhi Luo, Li Li, Zhong You

GEOMETRY AND BEHAVIOUR OF MASONRY VAULTS AND DOMES

G. Arun

Thursday Sept. 8th

Concurrent Session TH11

15¹⁵ – 16³⁰

Theory

G. Enescu Room (Hilton Hotel)

Normal lectures of 18 minutes

Chairmen : E. Gutierrez and D. Mihailescu

ULTIMATE STRENGTH OF CONCRETE CYLINDRICAL SHELLS REINFORCED WITH COMPOSITE CARBON FIBER UNDER POINT LOAD

K. Mashita, K. Kawasaki

EXPERIMENTAL STUDIES OF TOWER STRUCTURES WITH HYSTERETIC DAMPERS

Y. Ookouchi, T. Takeuchi, T. Uchiyama, K. Suzuki, T. Sugiyama, T. Ogawa, S. Kato

AN EXPLORATION INTO PERFORMANCE-BASED FIRE-RESISTING DESIGN METHOD FOR LARGE-SPACE TENSIONED STRUCTURES

Y. Bai, Y.J. Shi, Y.Q. Wang

STUDY UPON THE RC BOUNDARY WALLS OF FLAT SLAB STRUCTURES

A. Mircea, C. Dico

Coffee break

Thursday Sept. 8th

Concurrent Session TH12

16⁴⁰ – 18⁰⁰

Theory

Regina Maria I Room (Hilton Hotel)

Normal lectures of 18 minutes

Chairmen : D. Alaejos and A. Mihalache

EXPERIMENTAL VERIFICATION FOR LYFECYCLE MONITORING OF TRUSS DOME SYSTEMS

T. Hamamoto

DYNAMIC ANALYSIS OF CABLE-STRUT TENSION STRUCTURES

Zhou Ji, Zhang Qi-lin

REHABILITATION OF WATER TOWER IN THE CITY OF TARGU JIU, ROMANIA

C. Farcas

REPAIR AND RECONSTRUCTION OF SPATIAL STEEL STRUCTURES

J. Brodniansky, Z. Agócs

Thursday Sept. 8th

Concurrent Session TH13

16⁴⁰ – 18⁰⁰

Theory

D. Marcu Room (Hilton Hotel)

Normal lectures of 18 minutes

Chairmen : J. M^a Velasco Rivas and R. Popescu

DEVELOPMENT OF MEASUREMENT EQUIPMENT OF MEMBRANE STRESS - EVALUATION OF ADDED MASS EFFECT OF AIR

S.W. Jin, H. Ohmori

THE LOXODROMIC NETWORK AS A MODEL FOR THE RETICULATED DOMES

V. R. Marinov

THE EFFECT OF THE DEPTH OF EDGE BEAM TO THE MECHANICAL CHARACTERISICS OF THE FREE-FORMED REINFORCED CONCRETE SHELL

Y. Omori, M. Takayama

ON COUPLED BENDING-TORSION RESPONSE OF STRAIGHT BEAMS WITH CONSTANT CROSS-SECTION

F. Ibáñez, S. Monleón

Thursday Sept. 8th

Concurrent Session TH14

16⁴⁰ – 18⁰⁰

Theory

G. Enescu Room (Hilton Hotel)

Normal lectures of 18 minutes

Chairmen : M.D. Bostenaru and A.M. Dabija

OBSERVATIONS ON EXACTNESS OF STRUCTURES NUMERICAL ANALYSES

J. B. Obrebski

COMPUTATIONAL MORPHOGENESIS AND ITS APPLICATION TO STRUCTURAL DESIGN

H. Ohmori, H. Futai, T. Iijima, A. Muto, Y. Hasegawa

GENERATIVE CONCEPTUAL DESIGN OF DEPLOYABLE TENSION-STRUT STRUCTURES

K.K. Vu, J.Y. Richard Liew, Anandasivam Krishnapillai

FORMULATION OF DAMPING MATRIX AND ITS APPLICATION TO TENSION STRUCTURES

H. Matsubara, Y. Inoue, H. Ohmori, M. Wu

Thursday Sept. 8th

Working Groups

18⁰⁰ – 19⁰⁰

Theory (TH)

Regina Maria I Room (Hilton Hotel)

Technique (TECH)

D. Marcu Room (Hilton Hotel)

Valuation and Maintenance

G. Enescu Room (Hilton Hotel)

Friday September 9th

Departure

9^{uu} – 12^{uu}

Departure from Hotel Hilton, tour of Bucharest, visit of Village Museum, trip to Sinaia, visit Peles Castle .

Friday September 9th

Refreshment and coffee

12^{uu} – 12^{uu}

Friday September 9th

13^{uu} – 15^{uu}

Trip to Predeal and lunch to Rozmarin Restaurant

Friday September 9th

15^{uu} – 15^{uu}

Trip to Brasov

Friday September 9th

Brasov

15^{uu} – 18^{uu}

City Tour and visit Black Church and Sf. Nicolae Church

Friday September 9th

Trip

18^{uu} – 18^{uu}

Trip to Poiana Brasov

Friday September 9th

Poiana Brasov

18^{uu} – 19^{uu}

Hotel accommodation in Poiana Brasov.

Friday September 9th

Poiana Brasov

19^{uu} – 21^{uu}

Romanian dinner at Sura Dacilor (Dacian Shed) offered by the Mayor of Brasov.

Saturday September 10th

Special transport

7³⁰ - 12⁰⁰

Special transport from Hotel Piatra Mare (Poiana Brasov) to Otopeni airport

Saturday September 10th

Round Table

9³⁰ - 11⁰⁰

Round table on *Interference between Architectural and Civil Engineering Concerning Building Conception*

Moderators: J. Schlaich, L. Robertson, P. Teuffel, M. Mihailescu, S. Sturza

Coffee break

Saturday September 10th

Round Table

11¹⁵ - 12⁴⁵

Round Table on *Forecasting Spatial Structure Development*

Moderators: M. Kawaguchi, G.C. Giuliani, M. Levy, H. Berger D. Lungu, D. Constantinescu

Lunch 12⁴⁵ - 14¹⁵

Saturday September 10th

Closing Ceremony

14⁴⁵ - 16⁴⁵

Saturday September 10th

Banquet

19⁴⁵ - 22⁴⁵

Banquet offered by the Minister Delegate for Public Works and Fitting out Territory

Sunday September 11th

First variant

8⁰⁰ - 12⁰⁰

Departure from Piatra Mare Hotel route through Bran – Targoviste, Pitesti with one refreshment halt.

Sunday September 11th

First variant

8⁰⁰ - 14⁰⁰

Departure from Piatra Mare Hotel route through Bran – Targoviste, Pitesti with two halts: at Bran Castle 35' and Targoviste for 1h lunch